



Contract Holder

Contract GS-29F-0001N, Contract GS-14F-0029M



Creating a more comfortable place to work



freedom[®]

Task Chair

One million users can't be wrong. Winner of 10 international awards for its revolutionary design, the Freedom chair sets the gold standard by which other task chairs are judged. Its weight-sensitive recline and synchronously adjustable armrests provide exceptional comfort and lower the risk of long-term injury.

Available with adjustable arms, with fixed arms or armless.

Saddle and Pony Saddle

As the most comfortable and versatile stools ever made, the Freedom Saddle and Pony Saddle seats feature a triangular cushion that puts the spine into a healthy lordotic curve and reduces pressure points for ergonomic comfort.



Liberty[®]

Task/Conference Chair

The first mesh seating solution to achieve full lumbar support without an external device, Liberty offers dynamically adjusting recline and innovative Form-Sensing Mesh Technology for exceptional body-fitting comfort.

Available with adjustable arms, with fixed arms or armless.

Side Chair

Revolutionary mesh technology meets timeless design in the Liberty Side chair, which features a pivoting back and automatic lumbar support for ultimate comfort.

Available with fixed arms or armless.



Diffrient world[®]

Task Chair

Marking Humanscale's first foray into all-mesh task seating, the ultra-streamlined Diffrient World weighs only 25 pounds and is made from just eight major parts and 80 total parts. Its innovative, mechanism-free recline automatically adjusts to the needs of each user. The chair's tri-panel backrest hugs the body to provide tailor-made lumbar support, while its mesh seat eliminates contact stress.

Available with adjustable arms, with fixed arms or armless.





cinto[®]

Stacking Chair

Designed to move with the body and minimize pressure points, Cinto offers unprecedented ergonomic comfort for a chair in its class. Cinto's innovative backrest provides recline and automatically adjusting lumbar support, while its seat pan design uniquely distributes the sitter's weight.





element[™]

Task Light

Featuring advanced LED technology, Element Classic combines chic aesthetics with unmatched lighting performance. Using only five watts to produce incandescent lighting levels, Element Classic boasts a 50,000-hour lifespan—25 years of daily use in a typical 9-to-5 office environment.



element VISION[™]

LED Task Light

Task Light

A highly sustainable, adjustable and intelligent LED task light, Element Vision offers seven illumination levels, a Color Rendering Index (CRI) of 89, and a broad footprint of glare-free 3000K illumination that casts only one shadow. For further energy savings, Element Vision also features a Passive Infrared (PIR) motion sensor that automatically turns the light off or on when the user leaves or returns to the area.



Diffrient[™] Light

Work Light

Humanscale's Diffrient Work Light II maximizes the efficiency of compact fluorescent technology to provide cool, long-lasting illumination. The easily adjustable task light can support a wide variety of bulbs and features an asymmetrical, conical shade that minimizes glare and optimizes light distribution.

Flat Panel Monitor Arms

GSA Contract # GS-14F-0029M



M7™

M7 Monitor Arm

Winner of the prestigious Gold Award at NeoCon 2003, the M7 is an easily adjustable, stable and elegant flat panel monitor arm. Built to demanding specifications, the M7 has countless configurations is composed of 90% recycled materials.



M8™

M8 with Crossbar Monitor Arm

Combining rugged performance with sleek aesthetics, the M8 Monitor Arm is an ideal solution for heavy flat panel monitor applications. Using an optional crossbar, the M8 supports one or two monitors up to a total of 42 pounds. The M8's built-in, fine-tune adjuster allows easy re-positioning and improves the ergonomics of multiple-user workstations.



M|Flex™

Made to support current display technology and to easily adapt to future technologies, M/Flex accommodates up to six monitors from a single post or up to 12 monitors from two posts connected via crossbars. Exceptionally interchangeable, M/Flex allows users to easily configure and reconfigure their monitors without disrupting existing equipment.

Keyboard Supports

GSA Contract # GS-14F-0029M



Humanscale continues to advance the keyboard support category with intuitive adjustability, innovative design and exceptional construction. Since 1999, Humanscale has been the leading manufacturer of articulating keyboard systems, and today sells more than all other manufacturers combined.



CPU Holders

GSA Contract # GS-14F-0029M



CPU600™

Humanscale's CPU holders are safe and secure storage solutions for your technology investment.

Designed with clean lines and elegant aesthetics, the CPU600 offers the quickest and easiest installation of any CPU holder on the market, saving time and money. Its under-the-desk position provides valuable space savings, reduces cable clutter and promotes a longer life by allowing hardware to stay cool and vent freely.

Cable Management

GSA Contract # GS-14F-0029M



NeatLinks™

Designed to house and route cables, power strips and ballasts, NeatLinks offers protection for technology, organization for users, and quick and easy installation.

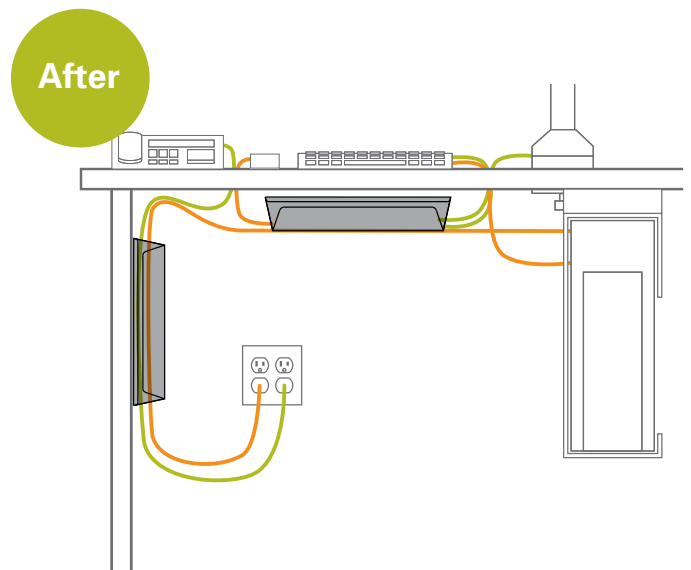
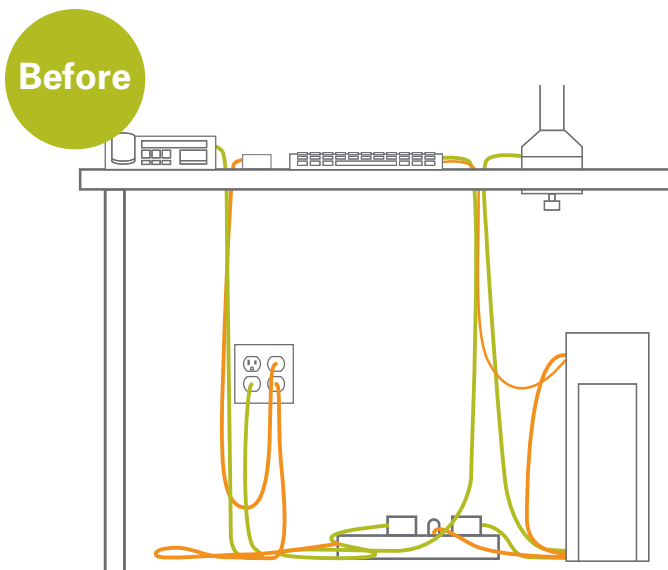

*Please note: Only certain Humanscale model numbers are GSA compliant.
Please contact your local Humanscale Representative for a full list of GSA compliant model numbers.*



Creating a more comfortable place to work

www.humanscale.com
800.400.0625